

nv35  
osnova prizemlja

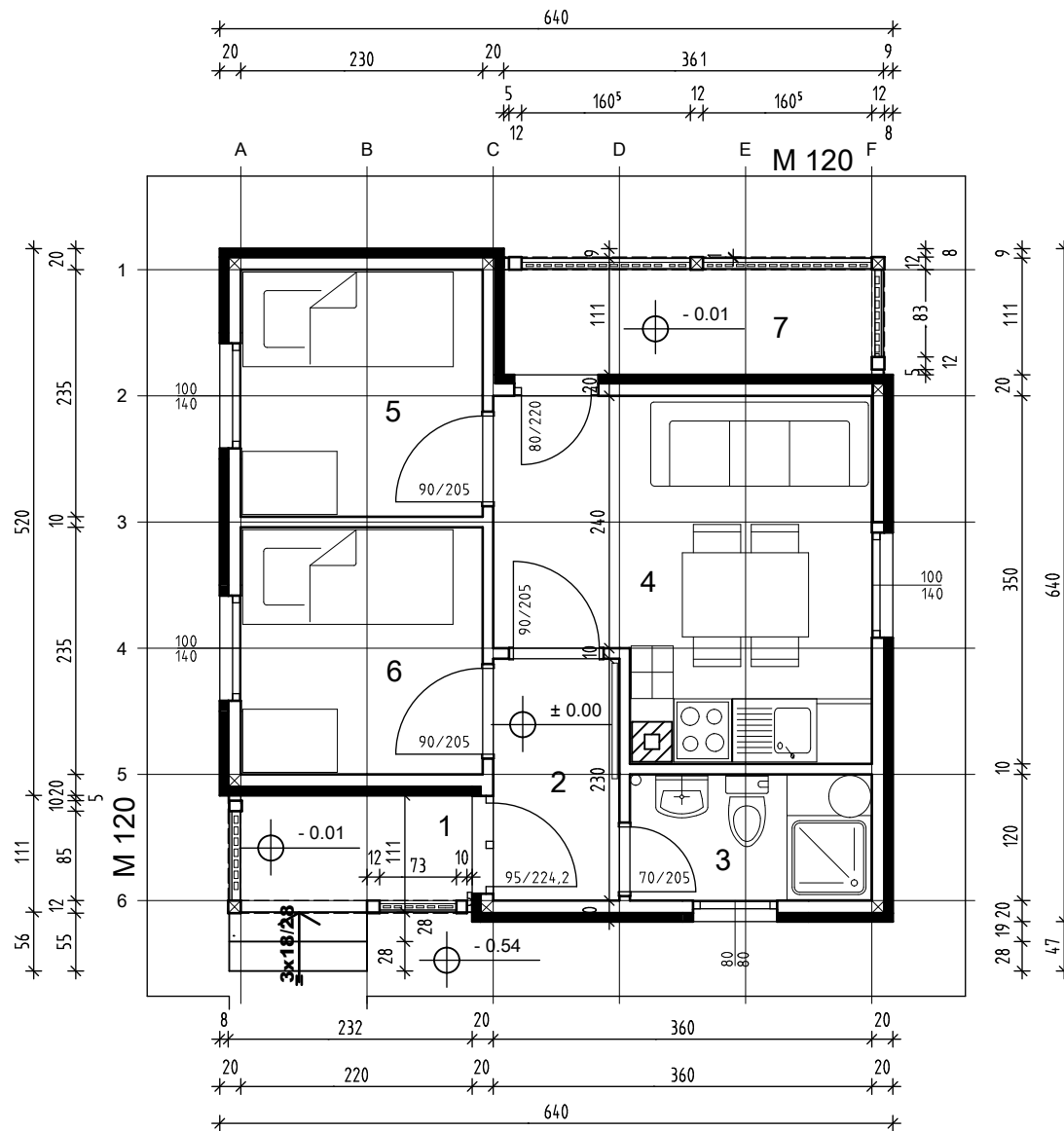

Legenda: Pm2

1. Ulaz	3.31
2. Predsoblje	2.76
3. Kupatilo	2.76
4. Dnevna soba	11.17
5. Spavaca soba	5.29
6. Spavaca soba	5.52
7. terasa	3.97

P(neto) = 34,78 m<sup>2</sup>

P(bruto) = 41,01 m<sup>2</sup>